



MADE TO WORK THE WAY **YOU** WORK



CRESCENT
RAILWORKS

**INDUSTRIAL
UTILITY CART**

CRESCENT RAILWORKS

CONFIGURE IT YOUR WAY.

Crescent RAILWORKS offers a modular material handling solution that adapts quickly to changing production needs. Featuring 8 unique accessory options, a versatile utility rail, and an adjustable handle, this is the only cart on the market that can be configured to work for you.

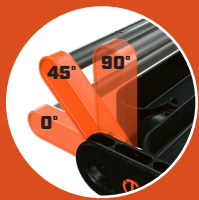

3 Position Comfort Grip Handle

Ergonomic handle adjustable from 0 - 90 degrees for optimal comfort

V-Notch

Holds pipe securely for safe cutting

Utility Rail-Lock System

Provides added durability and ability to attach various accessories and tools



Hard Casters

Non marring, locking 5 inch casters - 2 Swivel / 2 Fixed



Carts available in 5" and 8" casters

Structural Foam Shelves

HDPE crafted sturdy shelves 250lb capacity per shelf (total 500lb)



Maintenance

Line Repair

Electrical



INDUSTRIAL UTILITY CART

ACCESSORY OPTIONS

Base Cart



Industrial Utility Cart



Industrial Utility Cart with 8" Wheels

Bottom Secure Storage



Single Door Lockable Storage



Double Door Lockable Storage



Mesh Single Door Lockable Storage

Top Secure Storage



Lockable Flat Workstation



Lockable Angled Workstation



Wire Spool Holders

Accessories



Tool Drawer



Shelf Liner

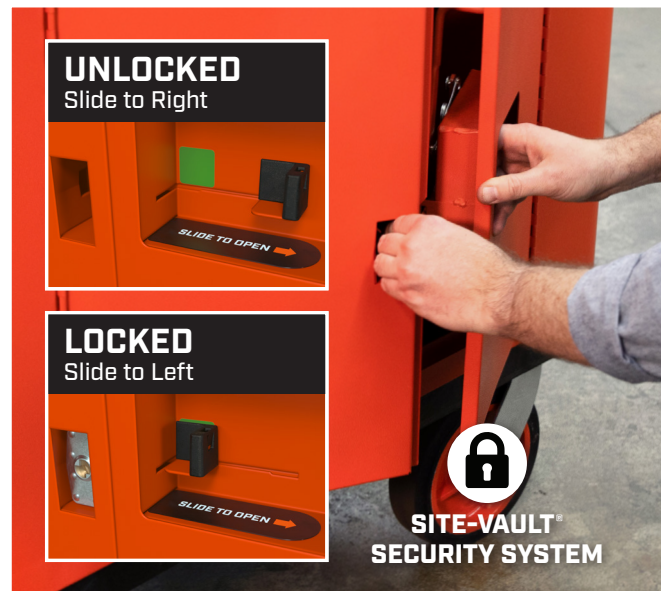

SITE-VAULT[®]
SECURITY SYSTEM



Customize your cart
by snapping accessories into
our exclusive rail-lock system

Made to Work the Way **You** Work

The RAILWORKS Cart System is built for versatility, adapting to a wide range of jobs with a unique lineup of accessories to configure your cart. Featuring the industry's most comfortable grip, adjustable to three positions, and a utility rail for effortless accessory integration, this cart ensures maximum comfort and efficiency. With our patented Site-Vault™ Technology, your tools stay secure, giving you peace of mind no matter the job. Enjoy endless configurations - all from a single manufacturer - streamlining your workflow and saving you time.

Cat. No.	Description	UPC	Length	Width	Height	Weight	Cases/Pallet
IUC2SCBM	Industrial Utility Cart	037103377463	42.81"	24.63"	8.75"	64.63 lbs.	6
IUC2S8CBM	Industrial Utility Cart with 8in Casters	043419380387	43.50"	30.00"	9.75"	87.86 lbs.	5
IUC1DLCRM	Single Door Lockable Storage	037103377487	40.75"	25.75"	10.00"	63.25 lbs.	5
IUC2DLCRM	Double Door Lockable Storage	037103379450	40.75"	25.75"	10.00"	65.25 lbs.	5
IUC1DMPLCRM	Mesh Panel Lockable Storage	037103379467	40.75"	25.75"	10.00"	56.25 lbs.	5
IUCPWCRM	Top Shelf Lockable Angled Workstation	037103379481	38.40"	21.90"	15.10"	47.60 lbs.	4
IUCFWLCRM	Top Shelf Lockable Flat Workstation	037103377494	38.10"	20.50"	10.40"	45.40 lbs.	6
IUCRCPCRM	Wire Spool Holders	037103377470	26.50"	3.88"	2.88"	7.00 lbs.	240
IUCSTDCRM	Tool Drawer	037103379498	24.61"	18.75"	7.93"	24.00 lbs.	15
IUCSL20CBM	Shelf Liner (20 Pack)	037103379603	36.69"	22.32"	3.35"	23.50 lbs.	26
IUCSL4CBM	Shelf Liner (4 Pack)	037103388322	36.69"	22.32"	0.88"	5.30 lbs.	90
IUC2SCBM-1DLR	Industrial Utility Cart with 5in Casters + Single Door Lockable Storage	037103381750	42.81"	24.63"	18.75"	127.88 lbs.	3
IUC2SCBM-2DLR	Industrial Utility Cart with 5in Casters + Double Door Lockable Storage	037103381774	42.81"	24.63"	18.75"	129.88 lbs.	3
IUC2SCBM-1DMPLR	Industrial Utility Cart with 5in Casters + Mesh Panel Lockable Storage	037103381767	42.81"	24.63"	18.75"	120.88 lbs.	3
IUC2SCBM-STDR	Industrial Utility Cart with 5in Casters + Tool Drawer	037103381743	42.81"	24.63"	16.68"	90.00 lbs.	4
IUC2SCBM-RCPR	Industrial Utility Cart with 5in Casters + Wire Spool Holders	037103381781	42.81"	24.63"	11.63"	70.93 lbs.	6
IUC2S8CBM-1DLR	Industrial Utility Cart with 8in Casters + Single Door Lockable Storage	037103402981	43.50"	30.00"	19.75"	151.11 lbs.	3
RAILWORKSPOP	Industrial Utility Cart, POP Merchandiser	037103388674	39.75"	38.50"	3.00"	71.13 lbs.	1

